

APPROVED	DATE	1962
CITY ENGINEER	NO. 12673	
REGISTERED CIVIL ENGINEER	NO. 2873	
CHECKED BY	DATE	
RECORDED	NO.	
CITY OF SAN BERNARDINO		
DEPARTMENT OF ENGINEERING		
CURB & GUTTER		
TIAJUANA STREET		
Between Eleventh Street and Baseline		

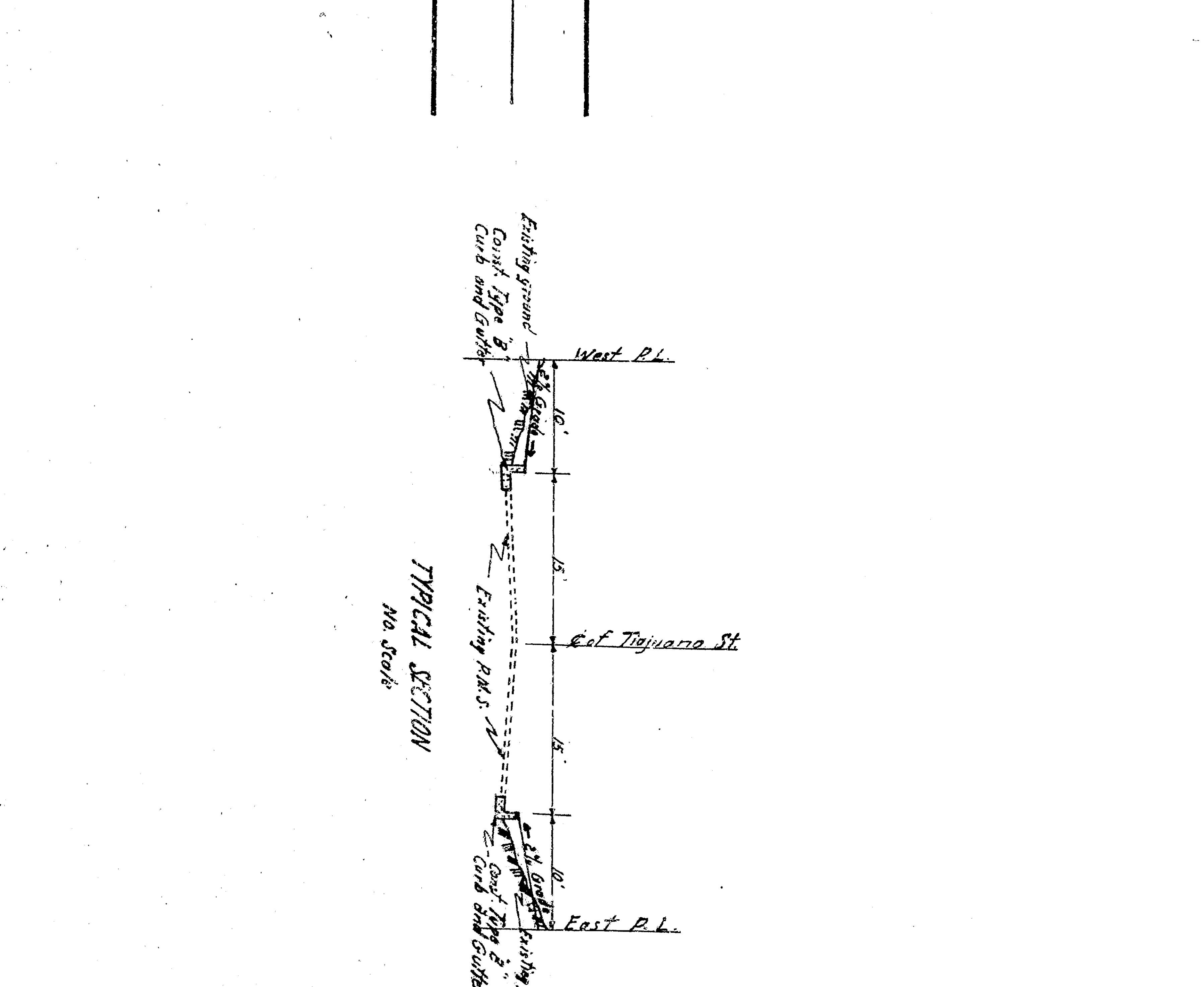

GENERAL NOTES

- All work covered on this plan shall be done in conformity with applicable provisions of standard specifications No. 2271 and standard drawings No. 2322 as filed in the office of the City Engineer.
- Recess curbs for driveway where necessary. Front location and width to be determined in the field with and directed by Streetman.
- Obstructions (manholes or pipes) as directed by Engineer.
- To be removed under this contract (Existing on Street signs shall be, Class B concrete, same as original installation.)
- To be removed and replaced by others.
- To be removed and replaced on adjacent property.
- Payment for all materials, labor, utility, sign installation, and adjusting sewer manholes to grade shall be included in price paid for work. Contract items of work are no additional compensation will be allowed herefor.

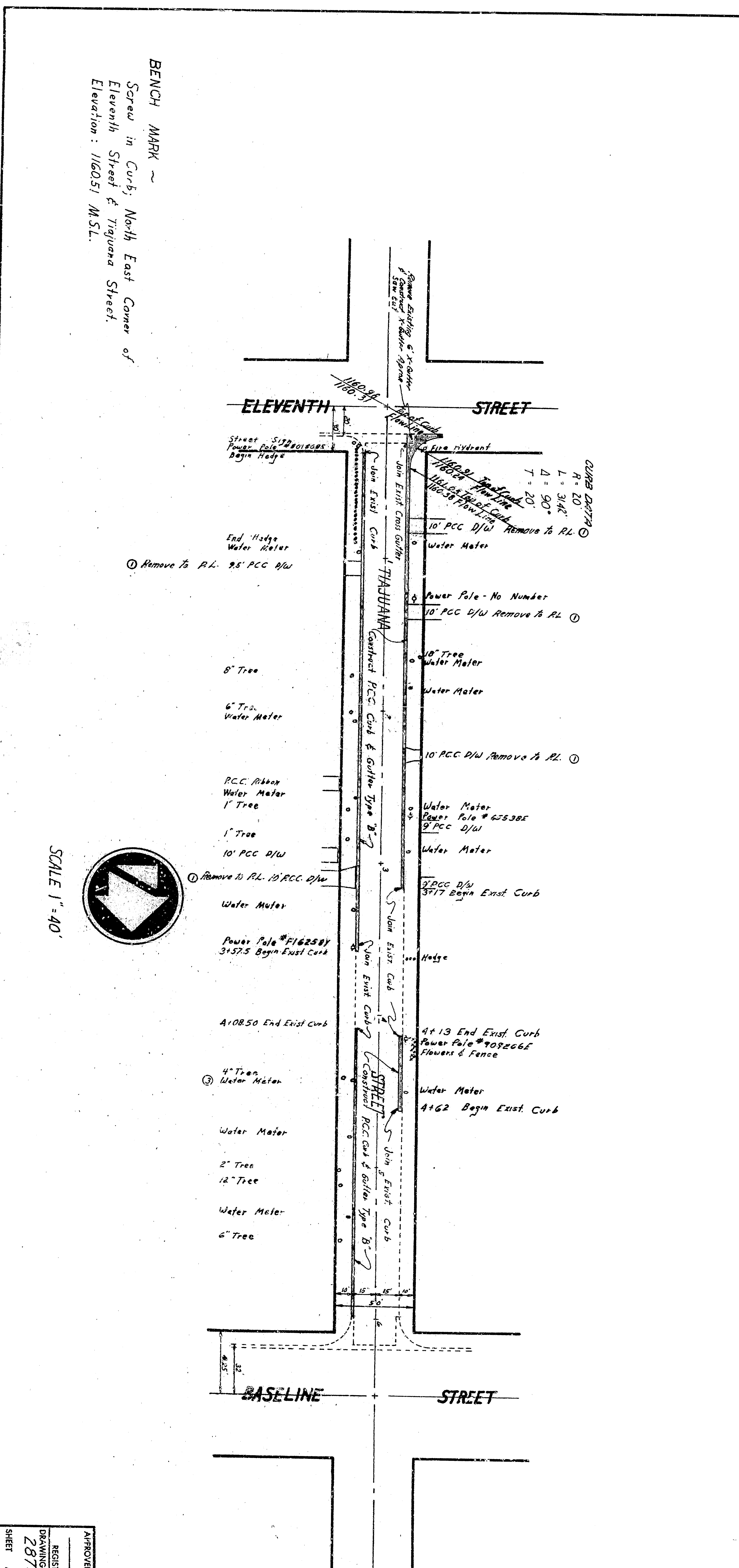

APPROVED	DATE	1962
CITY ENGINEER	NO. 12673	
REGISTERED CITY ENGINEER	NO. 12673	
DESIGNED BY	NO. 12673	
CHECKED BY	NO. 12673	
RECORDED BY	NO. 12673	
CITY OF SAN BERNARDINO		
DEPARTMENT OF ENGINEERING		
CURB & GUTTER		
TIAJUANA STREET		
Between Eleventh Street and Baseline		

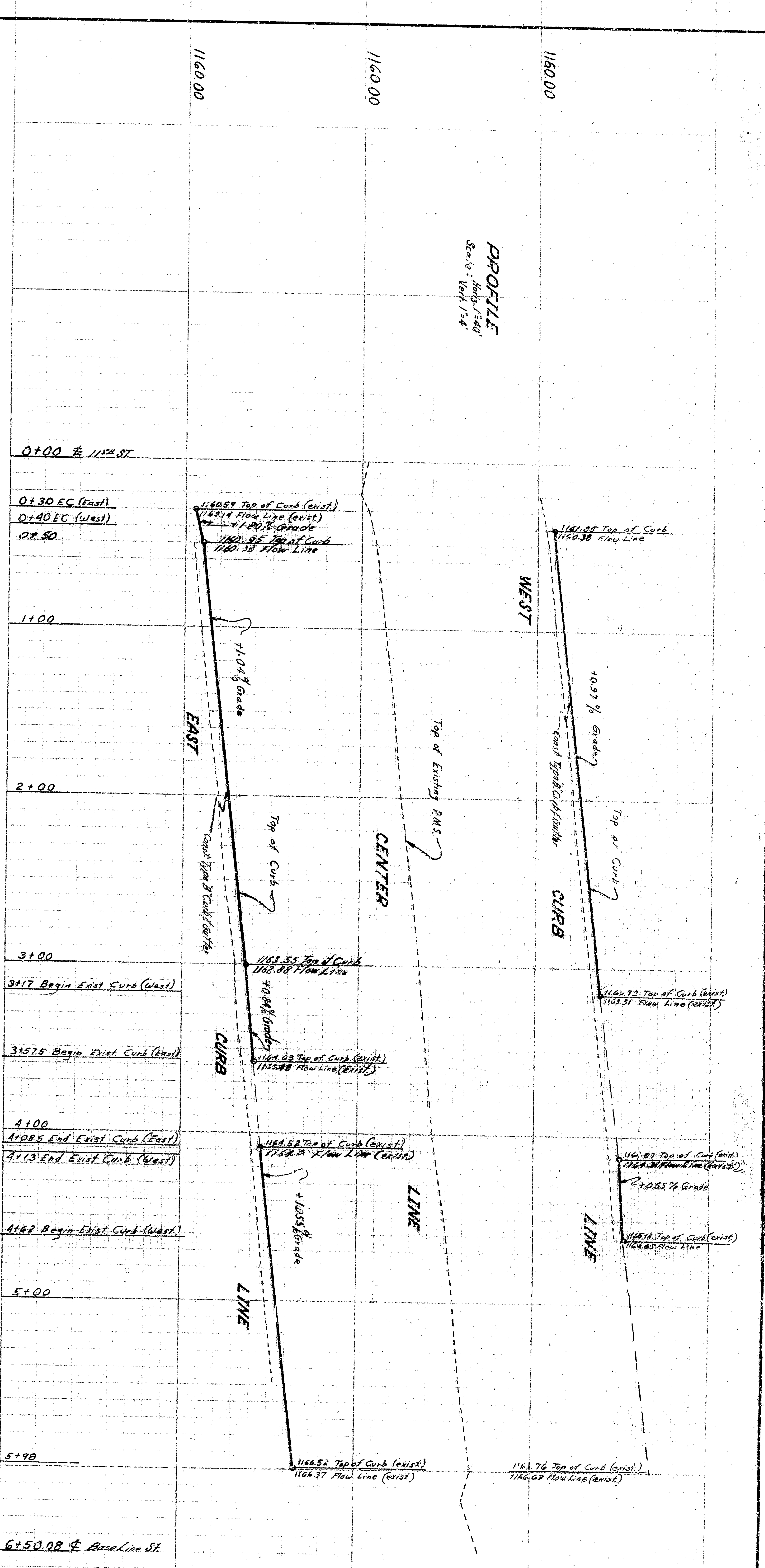

GENERAL NOTES

- All work covered on this plan shall be done in conformity with applicable provisions of standard specifications No. 2271 and standard drawings No. 2322 as filed in the office of the City Engineer.
- Recess curbs for drainage where necessary. Front locations and width to be determined in the field with and directed by the City Engineer.
- Obstructions (manholes, etc.) shall be directed by the City Engineer.
- To be removed, under this contract (Existing on Street signs shall be, Class B concrete, same as original installation.)
- To be removed and replaced by others.
- To be removed and replaced on adjacent property.
- Payment for all materials, labor, and utility, installation, and adjusting sewer manholes to grade shall be included in price paid for work, contract items of work, and no additional compensation will be allowed hereafter.

BENCH MARK ~
Screw in Curb, North East Corner of
Eleventh Street & Tijuana Street.
Elevation: 1160.51 M.S.L.

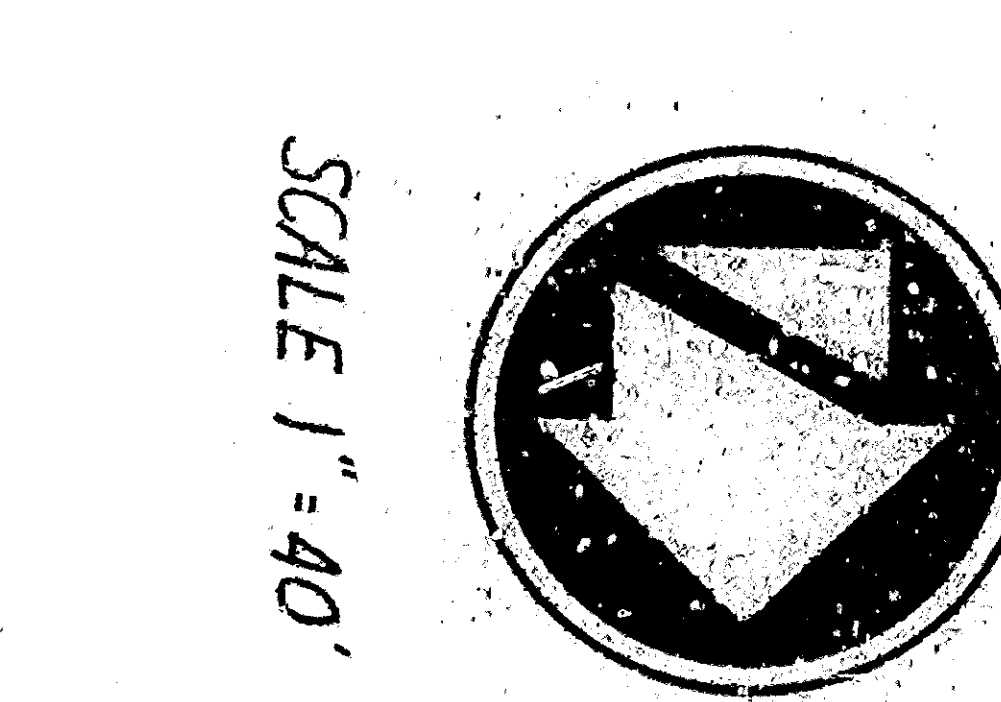

SCALE 1" = 40'

TYPICAL SECTION
No. 204

BENCH MARK ~
 Screw in Curb, North East Corner of
 Eleventh Street & Triunfo Street,
 Elevation: 116051 M.S.L.

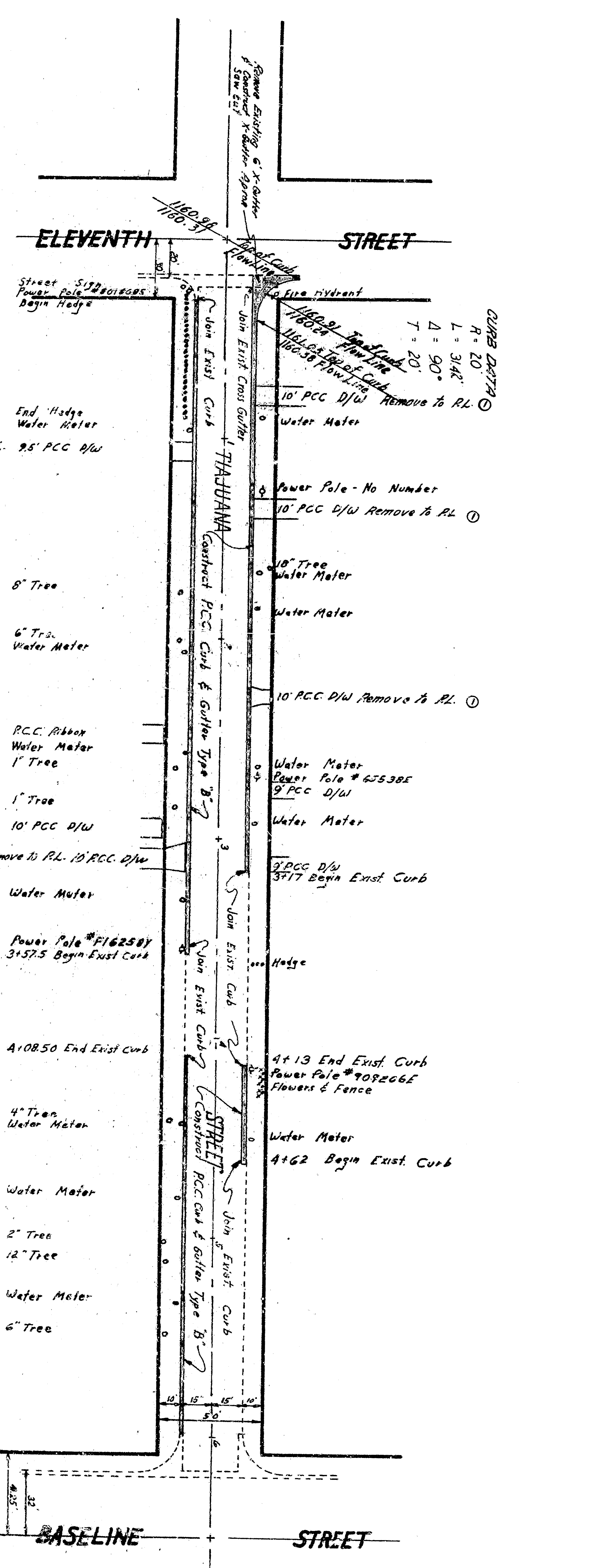

SCALE 1" = 40'

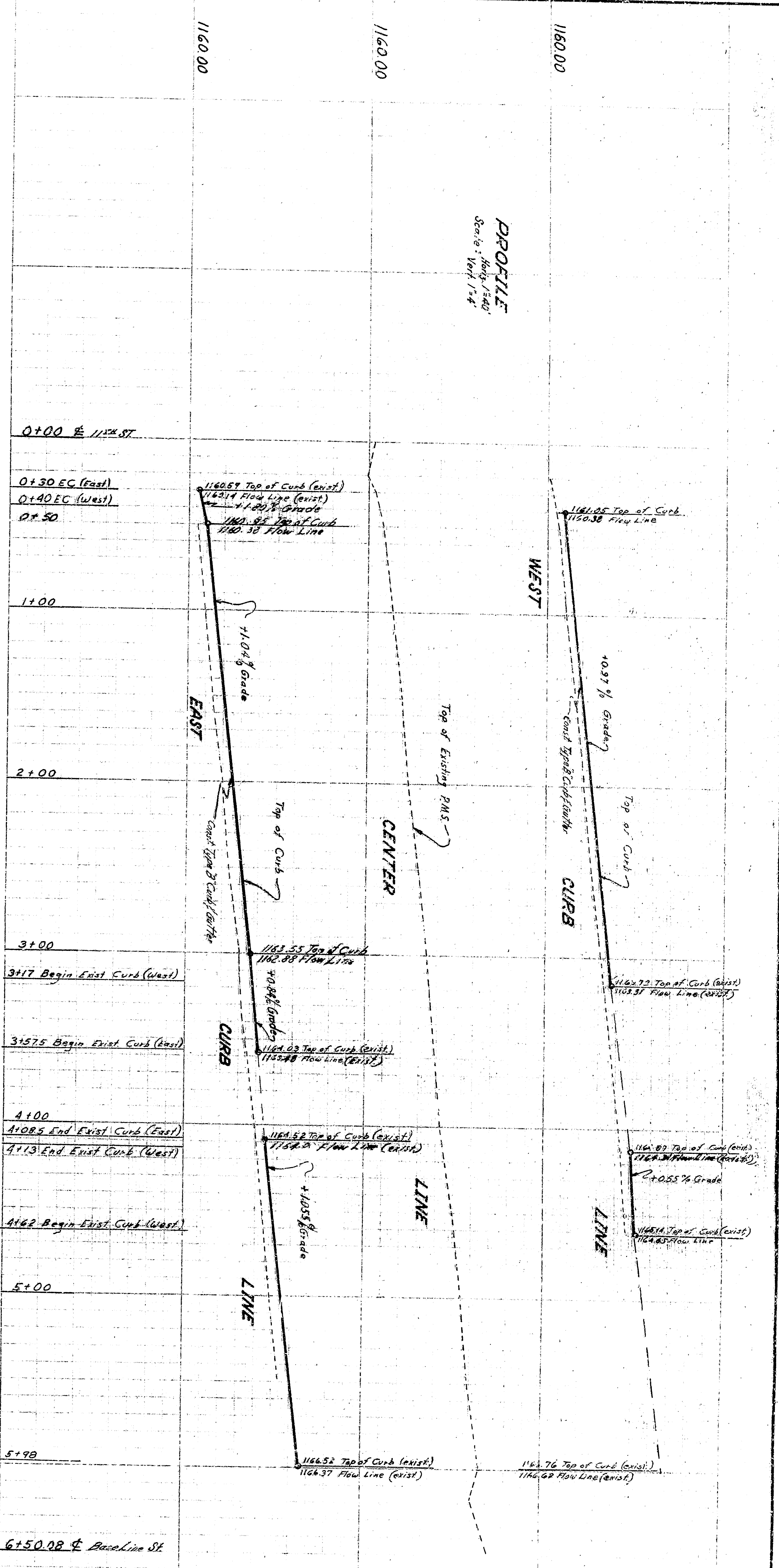
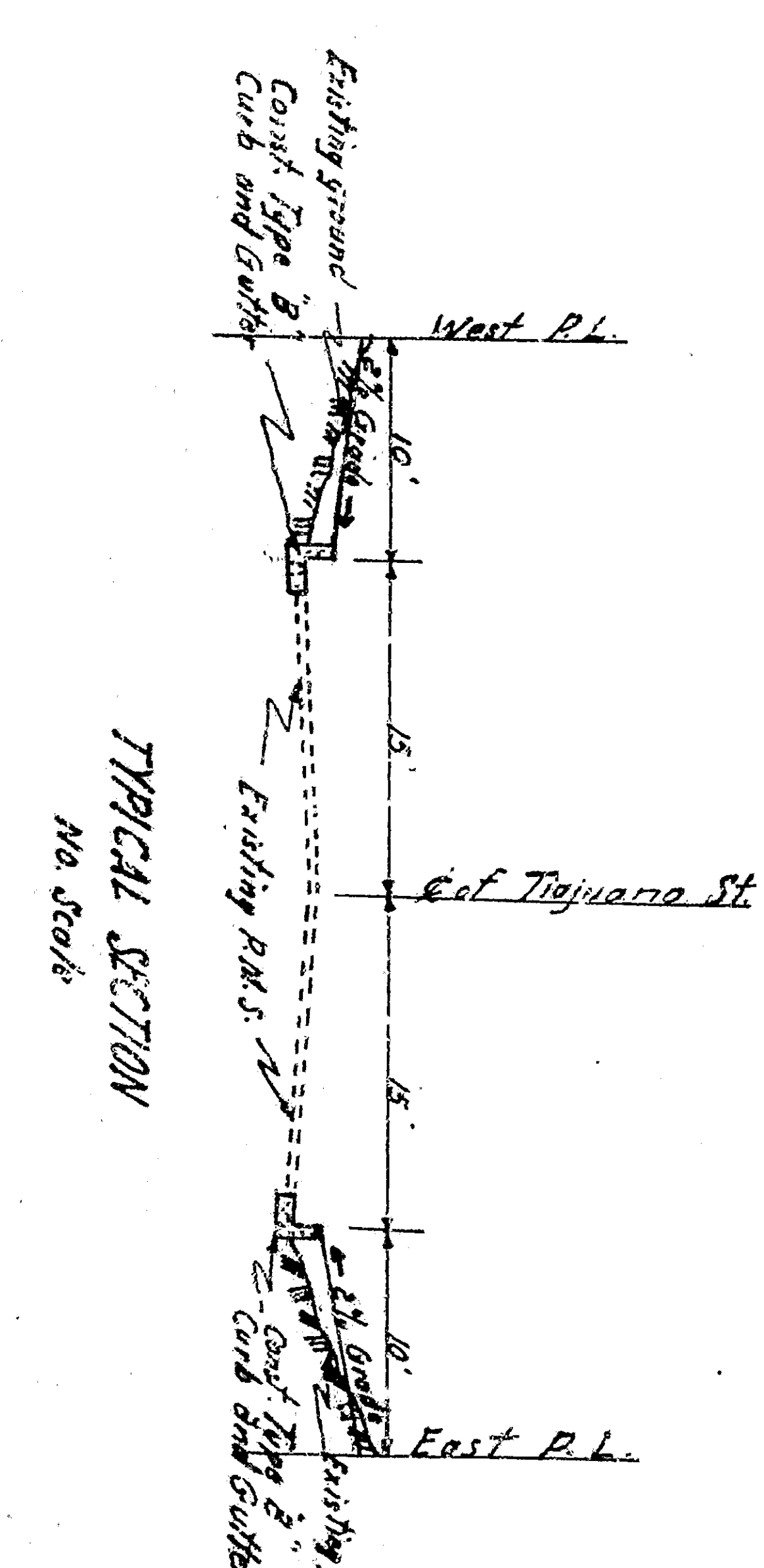

- GENERAL NOTES**
1. All work covered on this plan shall be done in conformity with applicable provisions of standard specifications No. 2271 and standard drawings No. 2522 as filed in the office of the City Engineer.
 2. Reexcavate curb form, driveway, where necessary. Excavate curbs and utility to be determined in the field with and the order of the Street.
 3. Obstructions (manholes or pipes) as directed by Engineer.
 4. To be removed, under this contract (Existing on Street signs shall be, Class B Concrete, same as original installation.)
 5. To be removed and replaced by others.
 6. To be removed and repaired on adjacent property.
 7. Payment for all materials, overhead, utility, sign installation, and adjusting street manholes to grade shall be included in prices paid for work, contract items of work, and no additional compensation will be allowed therefor.

APPROVED	1964
REGULATED CITY ENGINEER	
DESIGNED BY	2873
CHECKED BY	Blair
SHEET 1 OF 2	
REVISIONS	
CITY OF SAN BERNARDINO DEPARTMENT OF ENGINEERING	
CURB & GUTTER THIAUNA STREET	
Between Eleventh Street and Baseline	